

TREE PROTECTION PLAN

Tree No	DBH	RPA(m ²)	RPA equiv. to circle with rad. of
1	23	0867322	2.7
2	70	222	8.40
3	42	80	5.04
4	86	335	10.32
5	72	235	8.64
6	84	5813216	324
7	43	84	5.16
8	97	4371592	430
9	26	31	3.12
10	33	49	3.96
11	37	62	4.44
12	19	16	2.28
13	41	76	4.92
14	73	241	8.76
15	38	249163	56
16	90	366	10.80
17	55	137	6.60
18	40	72	4.80
19	48	104	5.76
20	47	100	5.64
21	85	0411665	327
22	46	96	5.52
23	52	122	6.24
24	56	142	6.72
25	60	163	7.20
26	33	49	3.96
27	45	92	5.40
28	40	72	4.80
29	34	52	4.08
30	46	96	5.52
31	45	8148448	95
32	43	6004587	86
33	62	174	7.44
34	36	59	4.32
35	39	59	4.68
36	27	33	3.24
37	69	7567201	220
38	47	100	5.64
39	84	314886	322
40	28	31	3.12
41	32	46	3.84
42	22	22	2.64
43	34	52	4.08
44	36	8917335	62
45	42	80	5.04
46	17	5783958	14
47	63	8200595	184
48	37	62	4.44
49	34	52	4.08
50	23	24	2.76
51	28	35	3.36
52	34	52	4.08
53	25	28	3.00
54	45	92	5.40
55	18	15	2.16
56	32	46	3.84
57	22	22	2.64
58	111	189028	559
59	124	835892	705
60	49	109	6.00
61	57	6888204	151
62	90	366	10.80
63	50	113	6.00
64	55	137	6.60
65	70	222	8.40
66	67	4240313	206
67	97	979376	209
68	38	65	4.56
69	28	35	3.36
70	96	8194108	424
71	55	686232	140
72	64	185	7.68
73	104	42222	493
74	62	1932472	175
75	33	841255	52
76	11	3137085	6
77	40	4227659	74
78	50	3189825	115
79	18	15	2.16
80	63	245532	181
81	116	704756	616
82	25	28	3.00
83	77	2204636	270
84	58	8517011	152
85	55	8726793	137
86	71	9583213	234
87	31	43	3.72
88	48	0832611	105
89	24	26	2.88
90	47	2969344	101
91	30	41	3.60
92	29	4108823	39
93	67	2829845	205
94	50	205608	114
95	56	5685425	145
96	62	2253967	175
97	26	4196896	32
98	38	6652299	68
99	38	65	4.56
100	46	2493243	97
101	24	5967478	27
102	74	8264659	253
103	70	9365914	228
104	99	6242942	449
105	103	580886	485
106	111	018017	558
107	38	1968585	66
108	27	8926514	35
109	39	5379797	71
2998	39	5979797	71
2999	27	8208555	35
3000	21	20	2.52

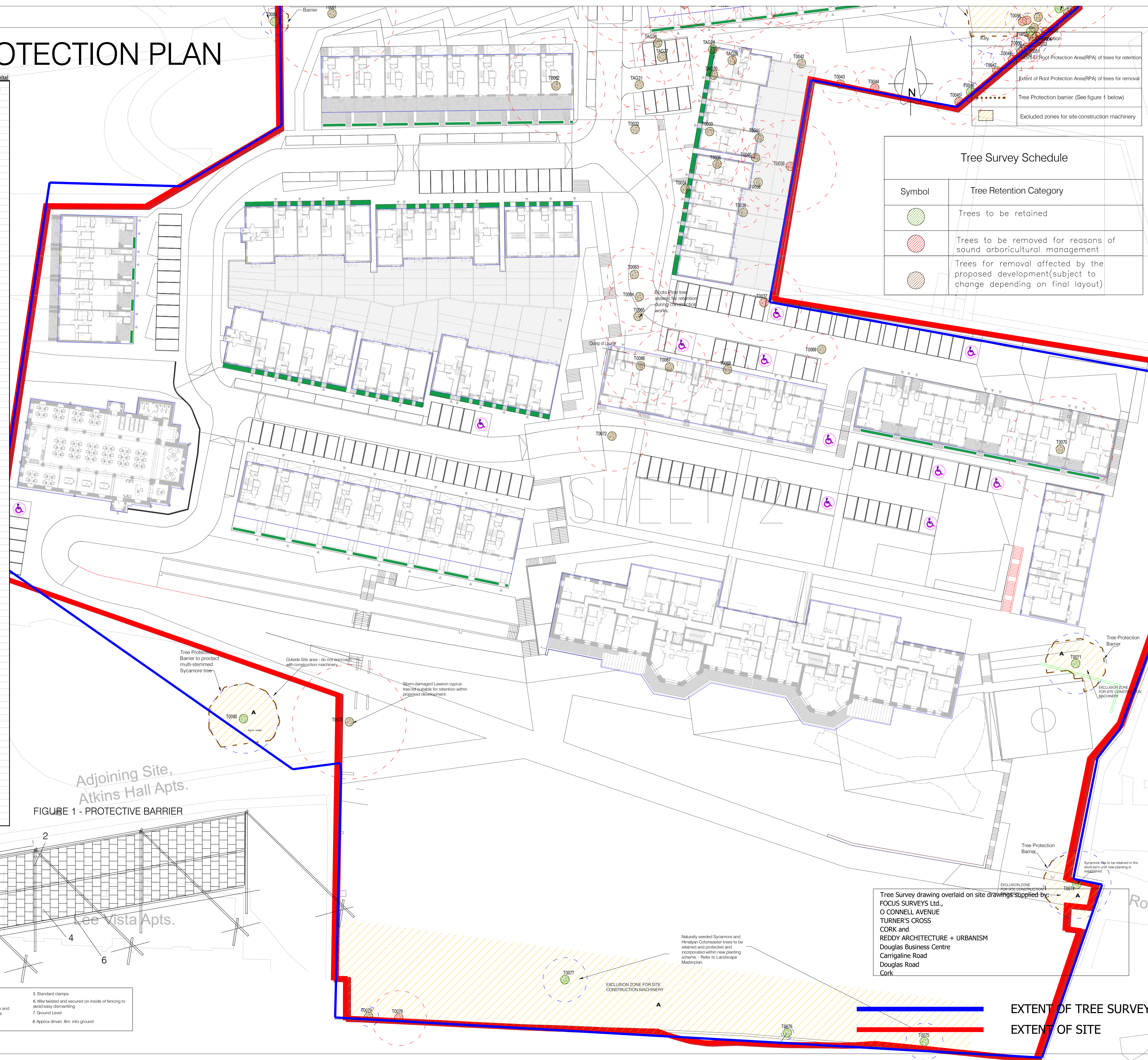

Tree Survey Schedule

Symbol	Tree Retention Category
	Trees to be retained
	Trees to be removed for reasons of sound arboricultural management
	Trees for removal affected by the proposed development (subject to change depending on final layout)

Notes:

This drawing to be read in conjunction with all relevant Architects & Engineers drawings & specifications.
 For construction and site works refer to Civil Engineering drawings.
 Do not scale from this drawing. Use figured dimensions only.

Refer also to our Tree Survey Report Ref: 19.11.SKH.01 carried out on 21st. February 2020.

Retained trees shall be reassessed on completion of any construction phase and may require remedial works in order to reduce risk.

Protection of retained trees shall be in accordance with BS 5837:2012 Trees in relation to Design Demolition and Construction - Recommendations.

Site Specific Tree Protection measures:

- To help protect existing root structures, no construction machinery shall enter into or traverse the hashed areas 'A' during the construction phase.
- Topsoil shall not be deposited within these zones and excess topsoil shall be moved off site.
- Any excavation along the verges of these zones shall be hand dug only, taking care not to damage or disrupt existing root patterns.
- Retain and protect individual trees of Sycamore and Cotoneaster in the lower grounds close to the southern boundary and incorporate with new proposed planting.
- Tree no. 0074 is a mature Sycamore and is growing close to walls and structures. Protect and retain in the short-term until new planting is established.

Adjoining Site, Atkins Hall Apts.

FIGURE 1 - PROTECTIVE BARRIER

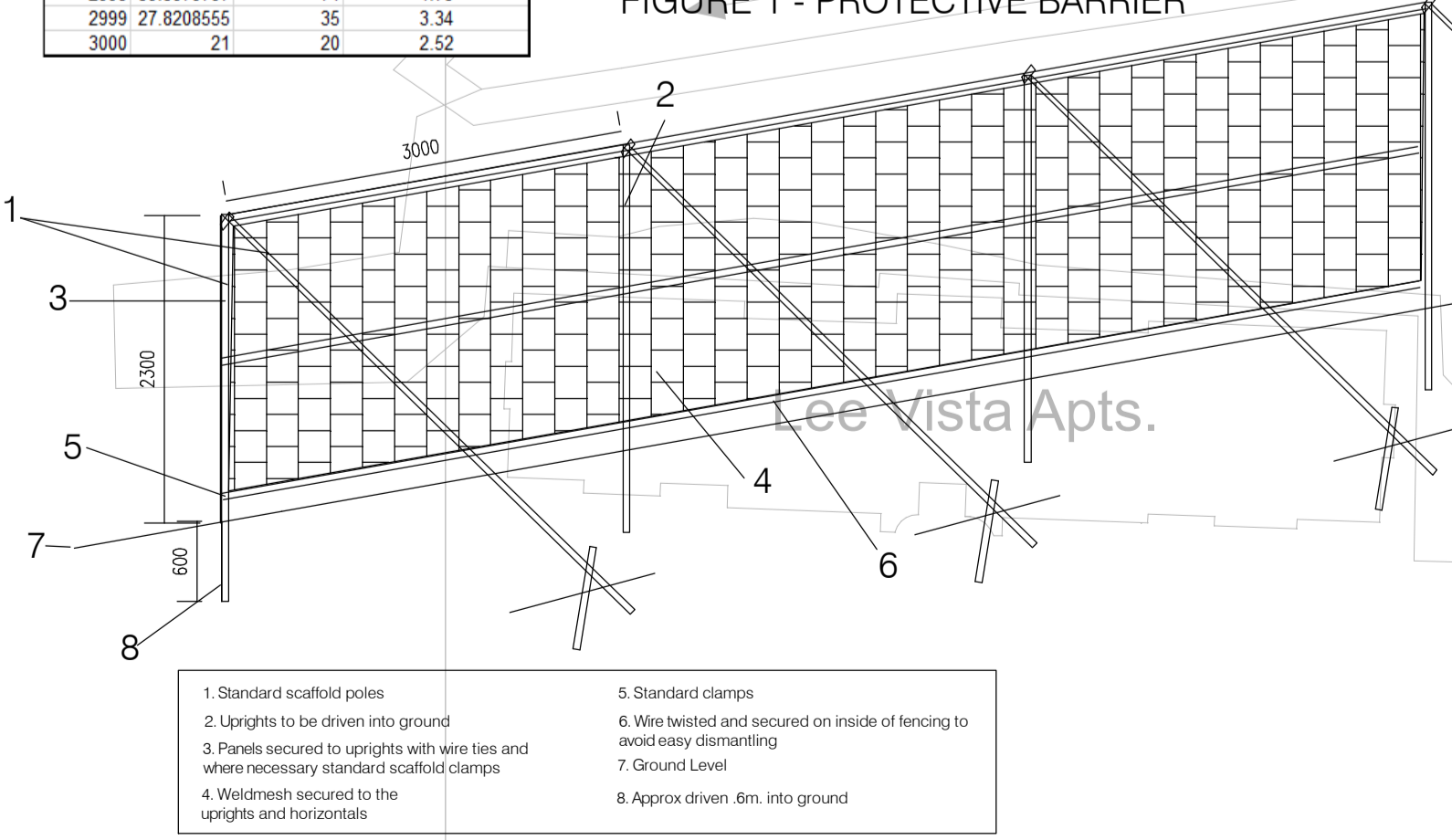

- Standard scaffold poles
- Sprights to be driven into ground
- Wires secured to sprights with wire ties and where necessary standard scaffold clamps
- Wire mesh secured to the sprights and horizontals
- Standard clamps
- Wire twisted and secured on inside of fencing to avoid easy dismantling
- Ground Level
- Approx driven 6m. into ground

Tree Survey drawing overlaid on site drawings supplied by:

FOCUS SURVEYS Ltd.,
 O'CONNELL AVENUE
 TURNER'S CROSS
 CORK and
 REDDY ARCHITECTURE + URBANISM
 Douglas Business Centre
 Carrigaline Road
 Douglas Road
 Cork

Tree Management Services
 Arboriculture, Landscape and Forestry Consultants
 21 Castletknock, Ballincollig, Co. Cork
 T: 021-4874365, M: 086 2532280
 Email: phelanlj1@gmail.com

PROJECT
 St. Kevin's Strategic Housing Development

CLIENT
 LAND DEVELOPMENT AGENCY

DRG. Ref: 20.04.SKH.02A STATUS: PLANNING SCALE: 1:400 @A1 approx.
 Date: 05-11-20 Sheet: 2 of 2

TREE PROTECTION PLAN

EXTENT OF TREE SURVEY
 EXTENT OF SITE